

# Total Drain Tanks

Integrated/load rated lifting lugs/tie-down points on roof



450mm hinged and vented lid



Tough one-piece molded construction



Water-fillable base to stabilise tank when tank is empty



5° cone bottom for full drainage



Side outlet



## SMARTER THAN YOUR AVERAGE STORAGE TANK

### FEATURES & BENEFITS

- Impervious polyethylene tank
- Suitable for a range of liquids
- Total drain 5 degree base
- 50mm ball valve standard
- Self supporting top
- Water fillable base
- Rated to 1.5 S.G
- 5 year warranty
- UV stabilised
- Ground fill option
- Side outlet
- Food grade

**BUILT SMART, BUILT TO LAST.**

CONTACT US

P 1800 502 267 E [sales@enmach.com.au](mailto:sales@enmach.com.au)

 **enmach**  
enmach.com.au

# TOTAL DRAIN / SELF DRAIN TANKS

## SIZE

→ 2500L, 5000L, 7500L, 10000L, 18000L, 24000L, 30000L & 35000L Capacities



PART NO.	S.G Rating	LITRES	DIMENSIONS	450MM LID HEIGHT	TOP FILL INLET	OUTLET	RRP PRICE (INC. GST)
<b>PTTD-2.5</b>	1.5S.G	2500L	2300mm dia x 1000mm high	900mm	As Required	2" Ball Valve	
<b>PTTD-5</b>	1.5S.G	5000L	2300mm dia x 1500mm high	1400mm	As Required	2" Ball Valve	
<b>PTTD-7.5</b>	1.5S.G	7500L	2300mm dia x 2100mm high	2000mm	As Required	2" Ball Valve	
<b>PTTD-10</b>	1.5S.G	10000L	2300mm dia x 2850mm high	2700mm	As Required	2" Ball Valve	
<b>PTTD-18</b>	1.5S.G	18000L	3200mm dia x 2700mm high	2600mm	As Required	2" Ball Valve	
<b>PTTD-24</b>	1.5S.G	24000L	3200mm dia x 3400mm high	3300mm	As Required	2" Ball Valve	
<b>PTTD-30</b>	1.5S.G	30000L	3200mm dia x 4150mm high	4000mm	As Required	2" Ball Valve	
<b>PTTD-35</b>	1.5S.G	35000L	3200mm dia x 4880mm high	4800mm	As Required	2" Ball Valve	

## How Do Total Drain Tanks Work?

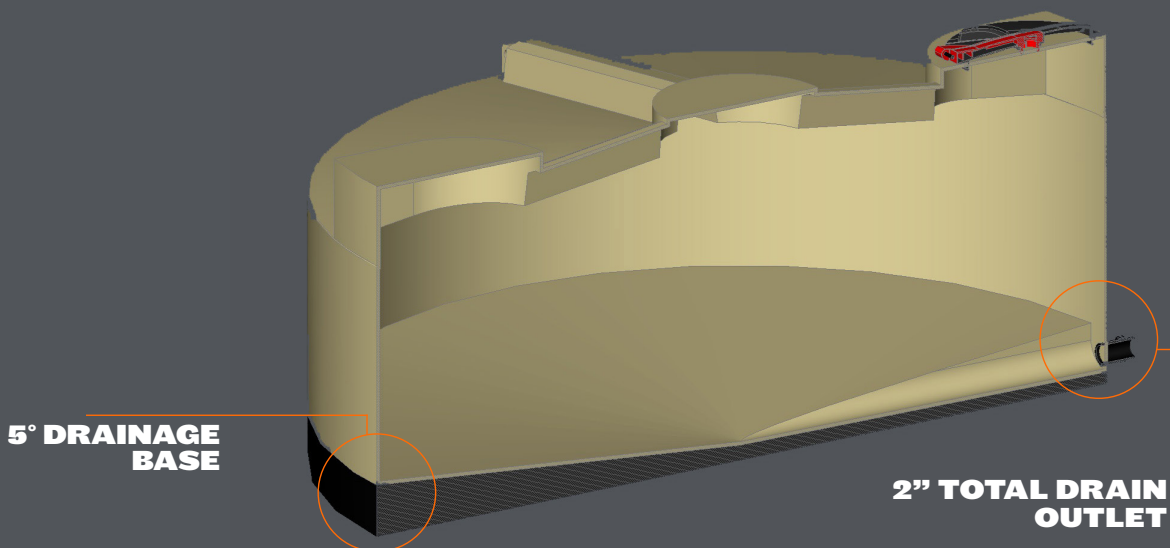

**BUILT SMART, BUILT TO LAST.**

CONTACT US

P 1800 502 267 E [sales@enmach.com.au](mailto:sales@enmach.com.au)

 **enmach**  
enmach.com.au